

## INFORMAZIONI PER UN FUNZIONAMENTO SICURO DEL TELECOMANDO

Il telecomando può essere utilizzato da bambini di età non inferiore a 8 anni e da persone con ridotte capacità fisiche, sensoriali o mentali, o prive di esperienza o della necessaria conoscenza, purché sotto sorveglianza oppure dopo che le stesse abbiano ricevuto istruzioni relative all'uso sicuro dell'apparecchio, nonché alla comprensione dei pericoli ad esso inerenti. I bambini non devono giocare con il telecomando. La pulizia e la manutenzione, destinata ad essere effettuata dall'utilizzatore, non deve essere effettuata da bambini senza sorveglianza.

**LEGENDA**  
Tasti

- A: SENSE
- B: BOOST
- C: fn
- D: fn
- E: STOP
- F: STOP
- G: Timer
- H: Light
- I: Light

**LEGENDA**  
Tipi di pressione sui tasti

- click
- click prolungato (2 s)
- click simultaneo prolungato (2 s)
- click simultaneo molto prolungato (10 s)

**ATTENZIONE!**  
Per controllare la cappa tramite telecomando eseguire la procedura di affiliazione (vedi paragrafo 1).

**IN CASO DI MALFUNZIONAMENTO**  
Seguire la procedura di assegnazione nuovo codice (vedi paragrafo 2). Scollegare e ricollegare la cappa alla rete elettrica. Ripetere la procedura di affiliazione (vedi paragrafo 1).

**\* ATTENZIONE!**  
Alcune funzioni contrassegnate con (\*), sono attivabili solo su alcuni modelli di cappa. Fare riferimento al manuale d'uso della propria cappa per maggiori informazioni.

**1 | AFFILIAZIONE TELECOMANDO**

**2 | ASSEGNAZIONE NUOVO CODICE FREQUENZA**

**3.1 | ASPIRAZIONE - AUMENTO VELOCITÀ**  
**3.2 | ATTIVAZIONE BOOSTER**

**4.1 | ASPIRAZIONE - DIMINUZIONE VELOCITÀ**  
**4.2 | SPEGNIMENTO CAPPA**

**5.1 | SENSORE QUALITÀ ARIA - ON/OFF**  
**5.2 | CALIBRAZIONE SENSORE**

**6 | SPEGNIMENTO AUTOMATICO TEMPORIZZATO**

**7.1 | LUCE - ON/OFF**  
**7.2 | LUCE - DIMMER (\*)**

**8.1 | LUCE AMBIENTE - ON/OFF**  
**8.2 | LUCE AMBIENTE - DIMMER**

**9 | LUCE - REGOLAZIONE TEMPERATURA COLORE: Luce calda/fredda**

**10 | SETTAGGIO TIPOLOGIA PIANO COTTURA (induzione/gas/elettrico)**

**11 | BLUETOOTH - ON/OFF**

**12 | BLUETOOTH - NUOVA ASSOCIAZIONE**

**13 | WI-FI - ON/OFF**

**14 | WI-FI - RESET CONFIGURAZIONE**

**15 | FILTRI GRASSI E ODORI - RESET ALLARME SATURAZIONE**

**16 | FILTRO GRASSI - ABILITAZIONE / DISABILITAZIONE ALLARME SATURAZIONE**

**17 | FILTRO ODORI - ABILITAZIONE / DISABILITAZIONE ALLARME SATURAZIONE**

**18 \*\* | MENU' FILTRI GRASSI E ODORI - ABILITAZIONE / DISABILITAZIONE ALLARME SATURAZIONE**

**ATTENZIONE**  
SU ALCUNI MODELLI, QUESTA FUNZIONE VIENE SOSTITUITA DALLA PROCEDURA DESCRITTA AL PUNTO 18 DI QUESTO MANUALE. \*

**\*\* ATTENZIONE**  
SU ALCUNI MODELLI QUESTA PROCEDURA SOSTITUISCE LE FUNZIONI DESCRITTE AI PUNTI 16 E 17 DI QUESTO MANUALE. \*

**INFORMAZIONI SULLA SICUREZZA**  
Utilizzare il telecomando con cura, contiene delicati componenti elettronici. Il radiocomando può danneggiarsi se fatto cadere, bruciato, perforato o schiacciato o se entra in contatto con sostanze liquide. Non aprire il telecomando e non tentare di ripararlo autonomamente. Se si tenta di disassemblare il telecomando, si potrebbe danneggiare.

**BATTERIA**  
Per la sostituzione delle batterie utilizzare unicamente la tipologia UM-3AAA/IEC R03. Non tentare di sostituire le batterie del telecomando con una tipologia diversa da quella precedentemente segnalata.

**SMALTIMENTO**  
Assicurarsi che il prodotto usato o le batterie siano smaltiti in modo sicuro in accordo con le normative ed autorità locali.

Con la presente si dichiara che questo radiocomando è conforme ai requisiti essenziali ed alle altre disposizioni pertinenti stabilite dalla direttiva 2014/53/UE.  
La dichiarazione di conformità può essere consultata al seguente link: <https://webdoc-dam.s3.eu-west-1.amazonaws.com/WebRoot/Certificati/CER000001.pdf>

**Elica**  
via Ermanno Casoli, 2  
60044 Fabriano AN Italy  
T +39 0732 6101  
F +39 0732 610249  
elica.com



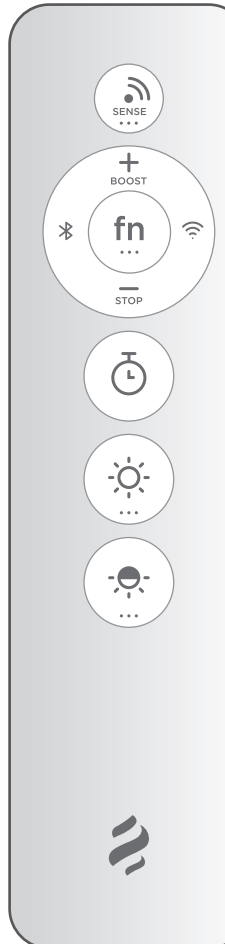

### INSTRUCTIONS FOR SAFE OPERATION OF THE REMOTE CONTROL

The remote control can be used by children who are younger than 8 years old and by persons with reduced physical, sensory or mental capacity, or without experience or the specific knowledge, as long as they are under surveillance or after they have received instructions regarding the safe use of the remote control and understand the dangers related to it. Children must not play with the remote control. The cleaning and maintenance that should be carried out by the user should not be done by unsupervised children.

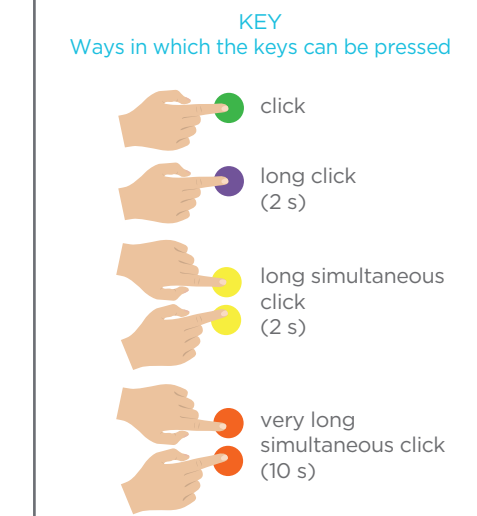
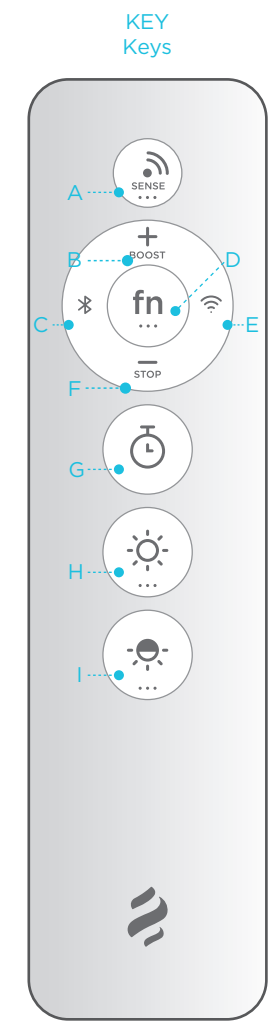

**CAUTION!**  
To control the hood via remote control, the affiliation procedure must be carried out (see paragraph 1)

**IF THERE IS MALFUNCTION**  
Follow the procedure for a new code allocation (see paragraph 2). Then disconnect and reconnect the hood to the power supply. Repeat the affiliation procedure (see paragraph 1).

**\* CAUTION!**  
Some functions marked here with an (\*) can only be activated on certain hood models. See the operation and maintenance manual of your specific hood for further information.

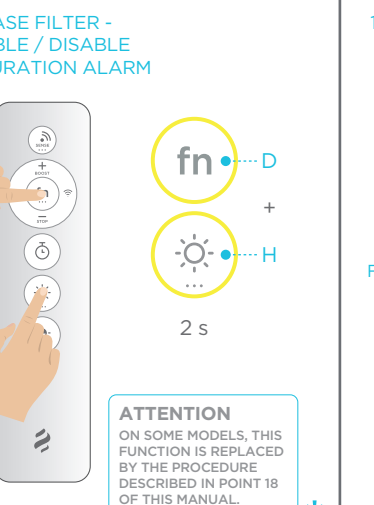
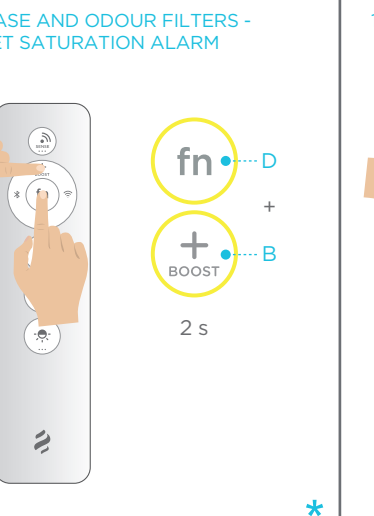
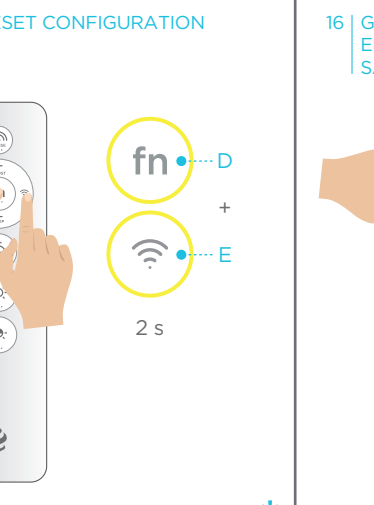
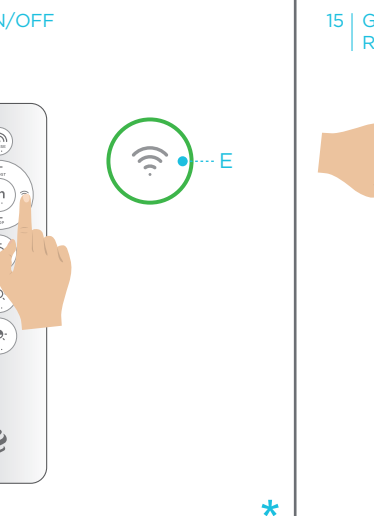
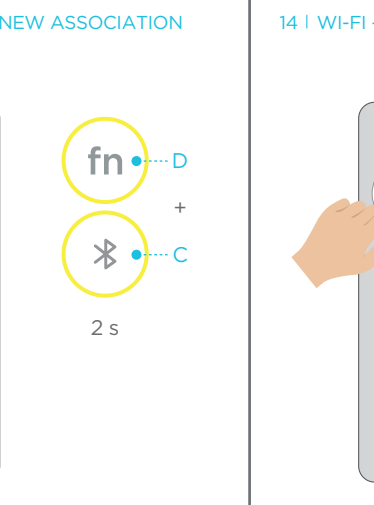
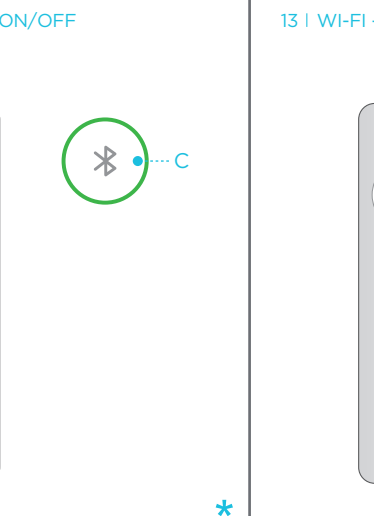
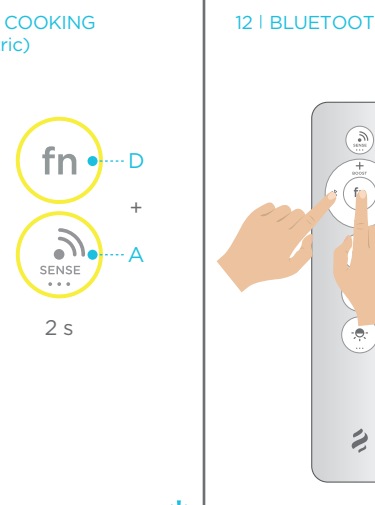
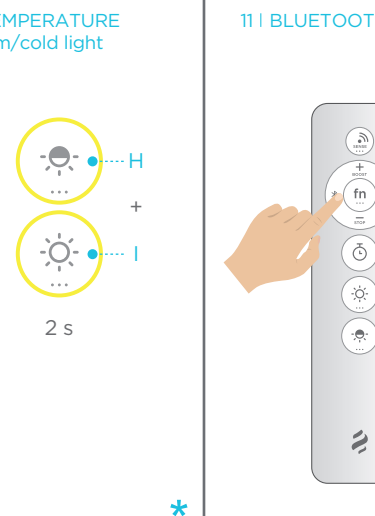
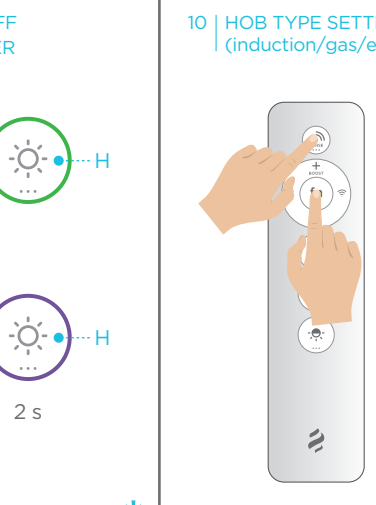
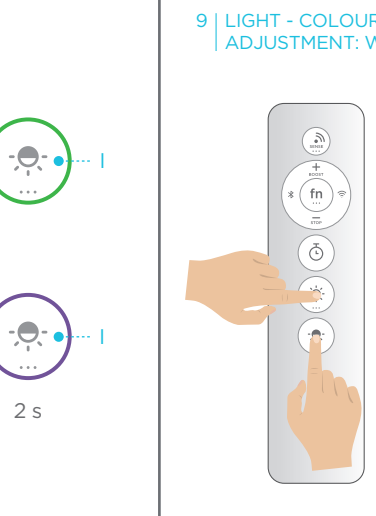
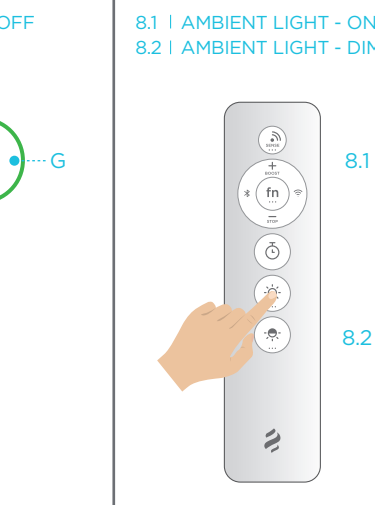
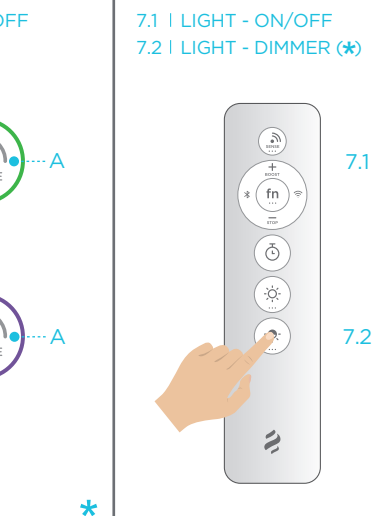
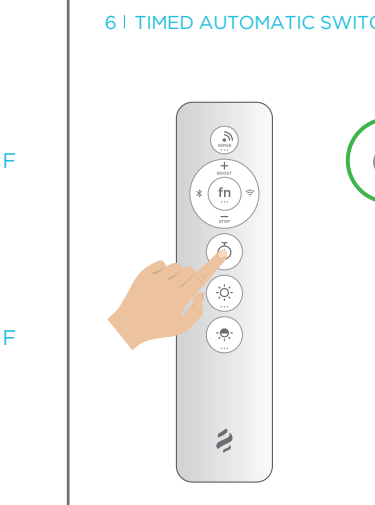
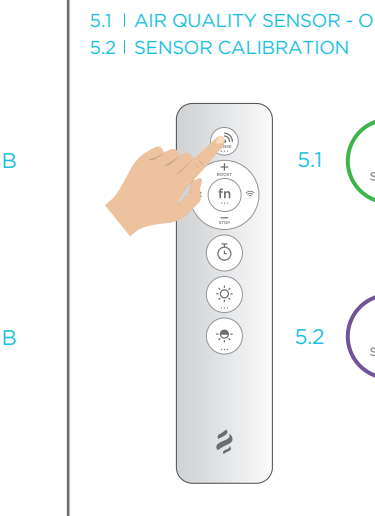
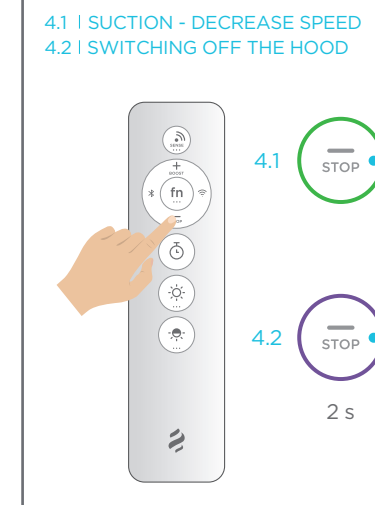
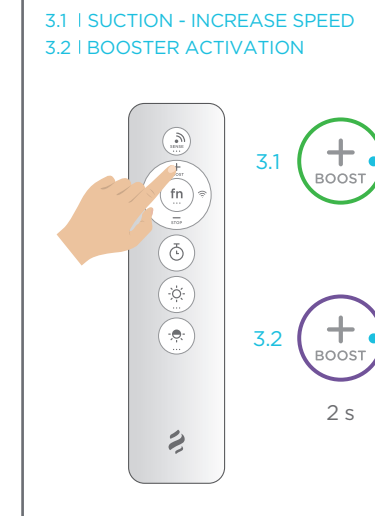
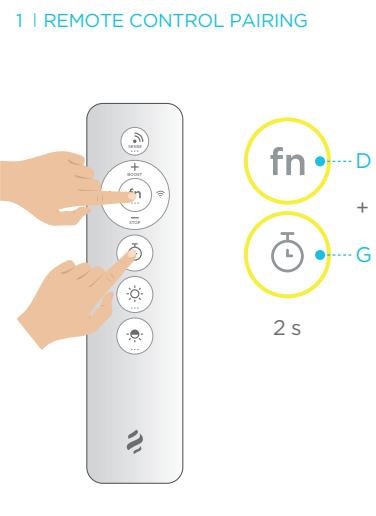

**SAFETY INFORMATION**  
Use the remote control with care; it contains delicate electronic parts. The remote control may be damaged if dropped, burned, pierced or crushed, or if it comes into contact with liquid substances. Do not open the remote control and do not attempt makeshift repairs. If the remote control is disassembled, it may be damaged.

**BATTERY**  
To replace the batteries, use only the UM-3AAA / IEC R03 type. Do not attempt to replace the remote control batteries with a type other than that previously indicated.

**ATTENTION**  
ON SOME MODELS, THIS FUNCTION IS REPLACED BY THE PROCEDURE DESCRIBED IN POINT 18 OF THIS MANUAL.

**ATTENTION**  
ON SOME MODELS, THIS FUNCTION IS REPLACED BY THE PROCEDURE DESCRIBED IN POINT 18 OF THIS MANUAL.

**ATTENTION**  
ON SOME MODELS, THIS PROCEDURE REPLACES THE FUNCTIONS DESCRIBED IN POINTS 16 AND 17 OF THIS MANUAL.

**BATTERY**  
To replace the batteries, use only the UM-3AAA / IEC R03 type. Do not attempt to replace the remote control batteries with a type other than that previously indicated.

**SAFETY INFORMATION**  
Use the remote control with care; it contains delicate electronic parts. The remote control may be damaged if dropped, burned, pierced or crushed, or if it comes into contact with liquid substances. Do not open the remote control and do not attempt makeshift repairs. If the remote control is disassembled, it may be damaged.

This certificate attests that this remote control is in compliance with the essential requirements and other pertinent dispositions established by Directive 2014/53/UE. The declaration of conformity can be consulted at the following link: <https://webdoc-dam.s3.eu-west-1.amazonaws.com/WebRoot/Certificati/CER000001.pdf>

**DISPOSAL WARNING**  
Do not dispose of electrical products in the general waste and ensure the used product or batteries are disposed safely according to your local authority and regulations.

**FCC WARNING STATEMENT**  
Changes or modifications not expressly approved by the party responsible for compliance could void the user's authority to operate the equipment. This equipment has been tested and found to comply with the limits for a Class B digital device, pursuant to Part 15 of the FCC Rules. These limits are designed to provide reasonable protection against harmful interference in a residential installation. This equipment generates uses and can radiate radio frequency energy and, if not installed and used in accordance with the instructions, may cause harmful interference to radio communications. However, there is no guarantee that interference will not occur in a particular installation. If this equipment does cause harmful interference to radio or television reception, which can be determined by turning the equipment off and on, the user is encouraged to try to correct the interference by one or more of the following measures:  
- Reorient or relocate the receiving antenna.  
- Increase the separation between the equipment and receiver.  
- Connect the equipment into an outlet on a circuit different from that to which the receiver is connected.  
- Consult the dealer or an experienced radio/TV technician for help.

**Ellica**  
via Ermanno Casoli, 2  
60044 Fabriano AN Italy  
T +39 0732 6101  
F +39 0732 610249  
elica.com

